

Please read this manual carefully for proper understanding of the correct method to use this product. Kindly retain for future reference.

emperor^{qoozo}

Environmental Ozonation + Filtration System
EM3018-S5



Gold Medal
36th International Exhibition of
Inventions Geneva (2008)
Best Health & Environmental Invention



Gold Medal
The Invention & New Product Exposition
(INPEX) America (2008)
Best Health & Environmental Protection



**Special Award for Innovative
Product (SIRIM)**
MITI Industry Excellence Award 2008



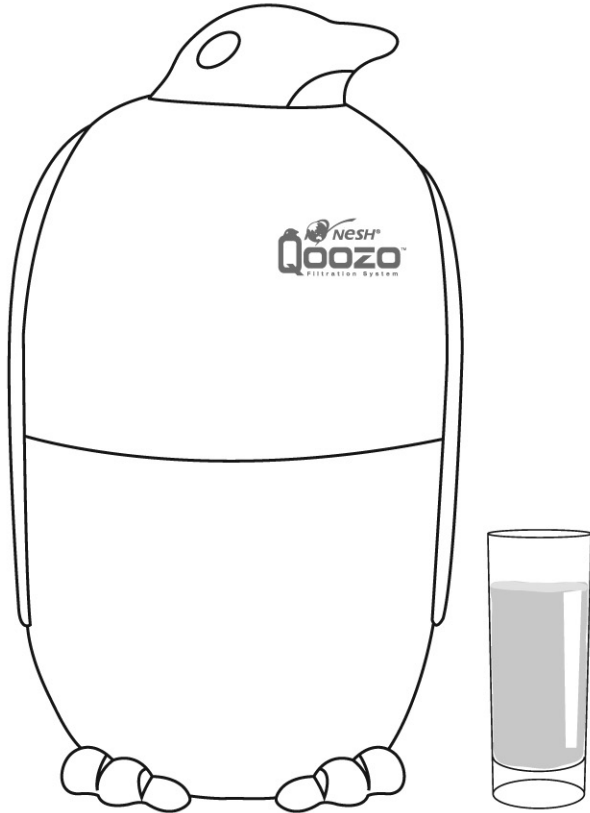

Product Information

EMPEROR QOOZO is an international copyrighted product featuring the unique 4312 system with the science of ozonation. The instantaneous fusion of Life Water and Ozone creates water that purifies, sterilizes and deodorizes. It can be used widely in our daily life.

| | |
|-------------------------------|---------|
| Safety Information |01 |
| Qoozo S5-1 Installation Guide |02 |
| Installation Guide |03 |
| Function Guide |05 |
| Operating Guide |06 |
| Care & Maintenance |07 |
| Troubleshooting |10 |
| Limited Warranty |11 |

EMPEROR QOOZO Environmental Ozonation + Filtration System

| | |
|----------------------------|---|
| Model | : EM3018-S5 |
| Weight | : 4.8 kg \pm 5% |
| Size | : 37cm (H) X 21.3cm (W) |
| Voltage | : DC12V  |
| Power Consumption | : 16.5W (Max) |
| Ozone Concentration Level: | 100-150mg/hr(selectable) |

Safety Information

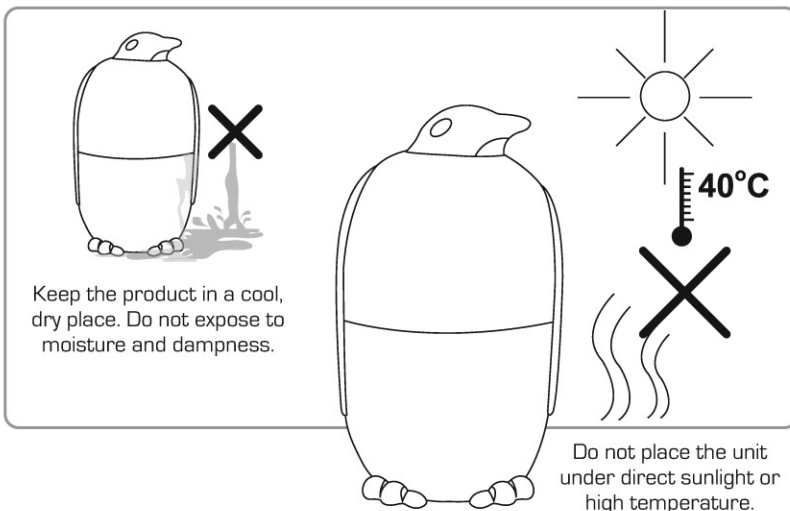
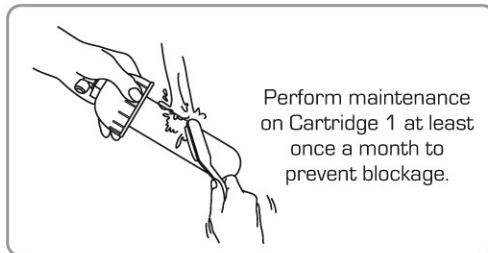
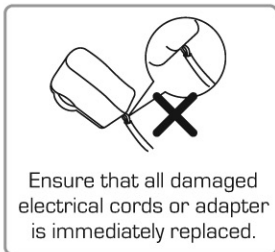

- Only use a suitable external power supply.
- Do not bend, modify or over-twist the electrical cord.
- Do not place heavy objects on the electrical cord.
- Make sure that the power source is switched off/unplugged before moving away the product or carrying out the maintenance.
- Unplug the adapter when the product is not in use for a long period of time.
- Keep the product away from children.
- Do not attempt to dismantle or repair the product when the product is faulty. Kindly contact our Customer Careline for assistance.
- The frequency of replacement of cartridge depends on domestic water quality and usage.
- Do not block or close the ozone air vent.
- Do not modify or change the outlook and design of the product.
- This product is to be solely used on standard water supplies provided by utility boards and treatment plants recognized by the government.

QOOZO S5-1 INSTALLATION GUIDE

EMPEROR QOOZO Filtration System comes with a range of parts and accessories to accommodate and complete your water filtration and ozonation process.

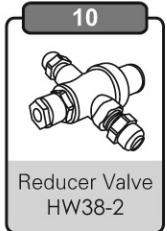
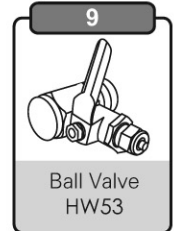
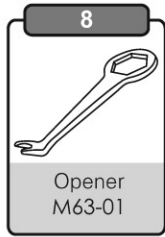
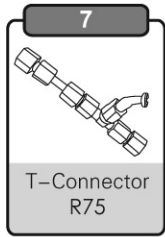
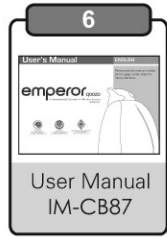
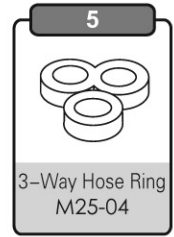
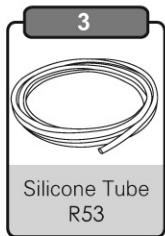
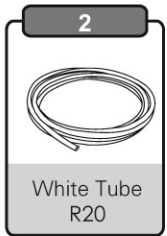
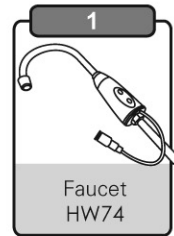
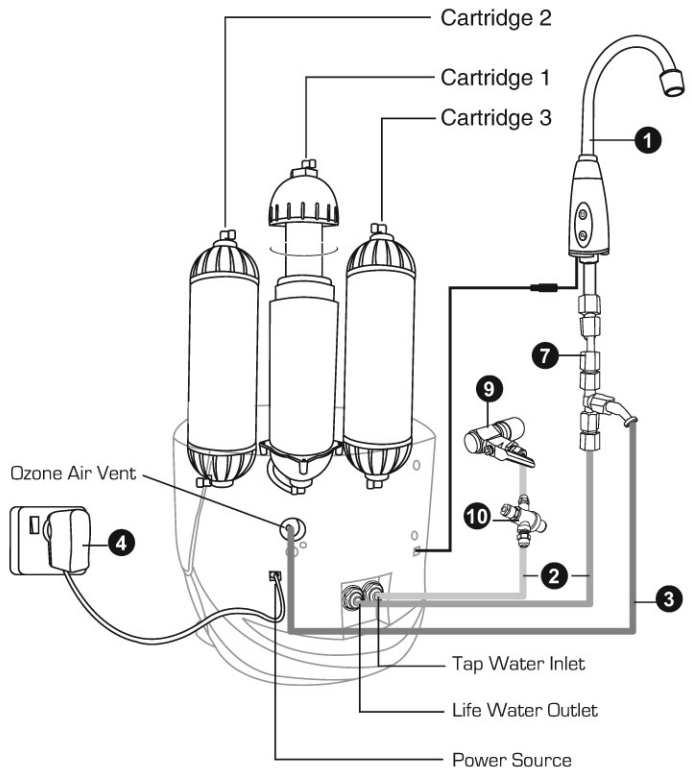

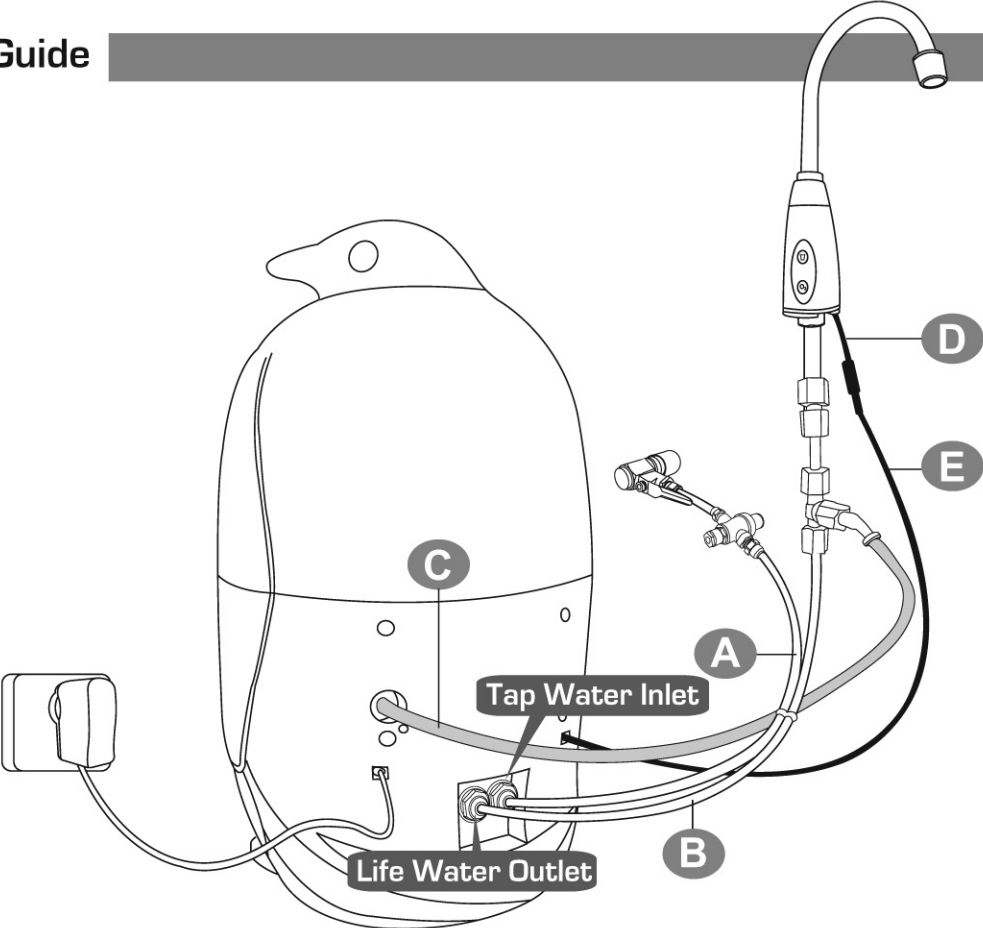

Installation Guide

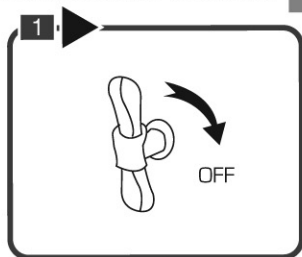

Turn OFF the main water supply.

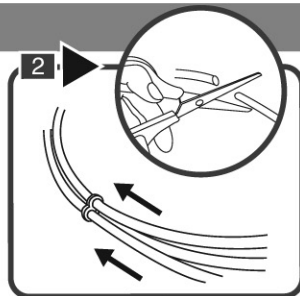

Cut the white tube into required length. Then tie the white tubes and silicone tube together using the 3-way hose ring.

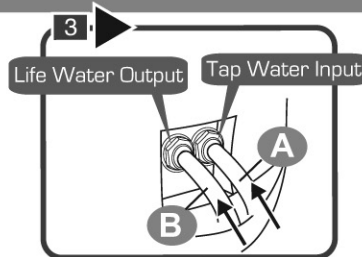

Insert white tube A to the right. Insert white tube B to the left.

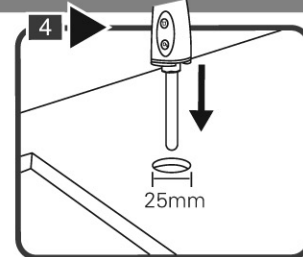

Install the faucet. Please ensure that the diameter of the hole for installing the faucet is 25mm.

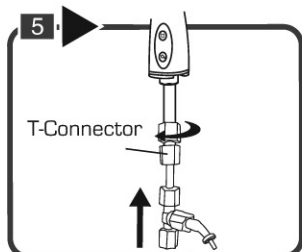

Insert T-Connector into the faucet.

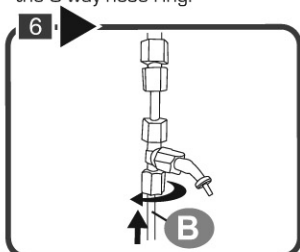

Insert white tube B into the T-Connector.

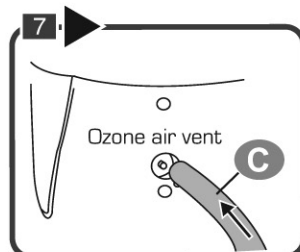

Insert silicone tube C into the ozone air vent.

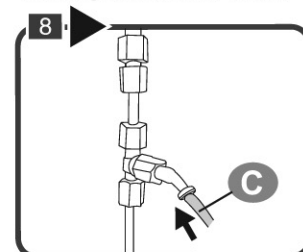

Insert silicone tube C into the T-Connector

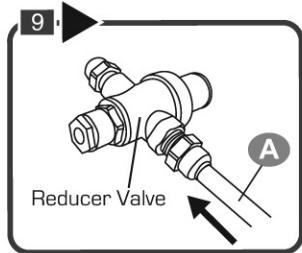

Insert white tube A into the reducer valve

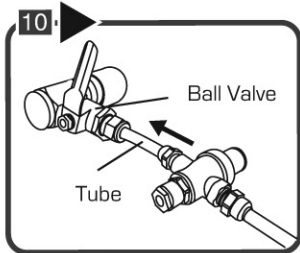

Connect the reducer valve to the ball valve.

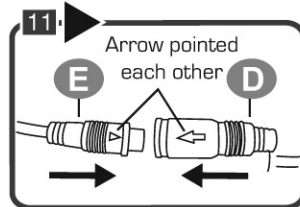

Connect electrical cord D and faucet electrical cord E together.
Attention: Make sure that arrows are pointed to each other before connection.

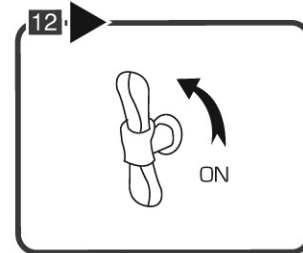

Turn ON the main water supply.

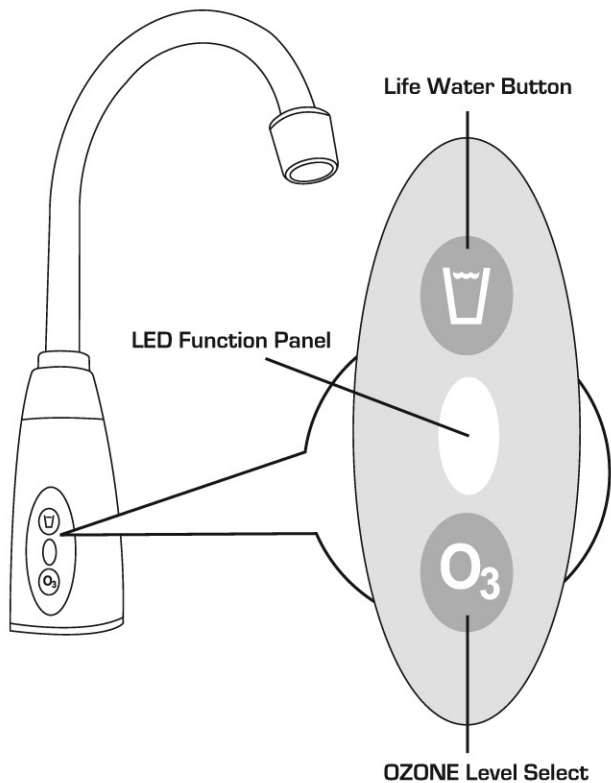

The concentration of ozone increases from Level 1-3:

- 1** LIFE WATER

Level 1: Blue LED
Function: Life Water consumption

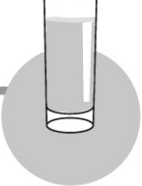
- 2** MEAT/ SEAFOOD

Level 2: Yellow LED
Function: Cleaning seafood and meat



- 3** VEGGIES/ FRUITS

Level 3: Green LED
Function: Washing vegetables and fruit

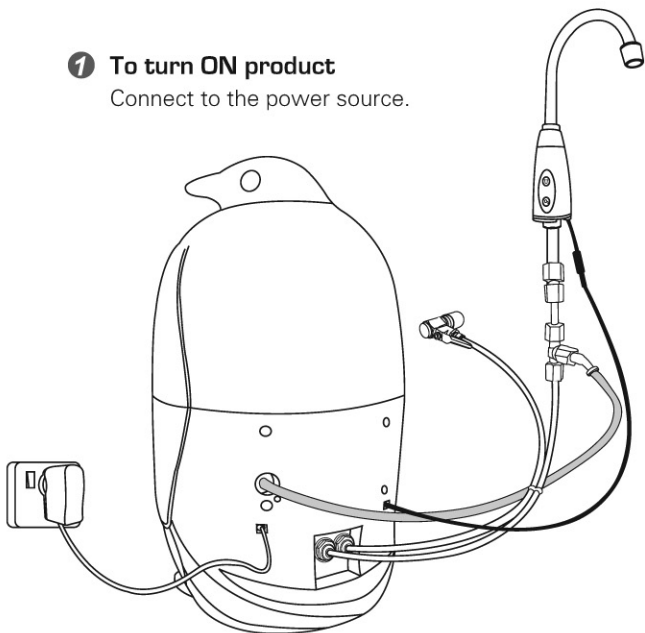

1 To turn ON product

Connect to the power source.



2 To select levels

a) Press  button for Life Water

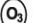
b) Press  button for Level 2 or 3 Ozone function.

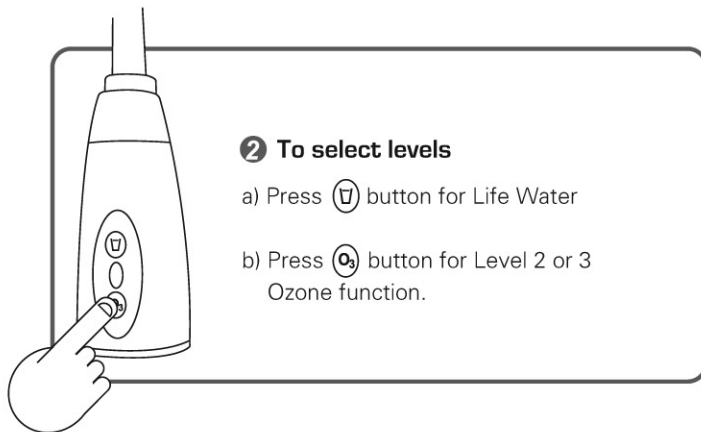

OFF

3 To turn OFF product

Switch off the power source and unplug from the socket.



4 Safety features

To prolong the lifespan of the product, Level 2 and 3 will automatically revert to Level 1 after 3 minutes of continuous usage. Reselect Level 2 or 3 to continue using the Ozone function.

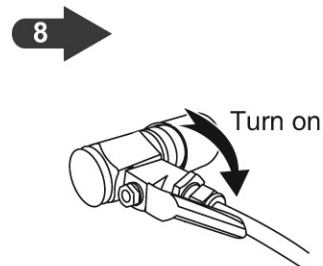
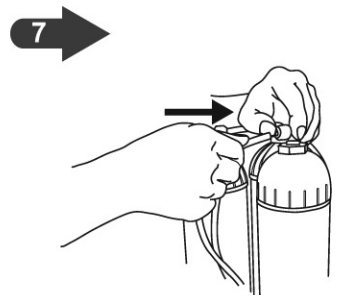
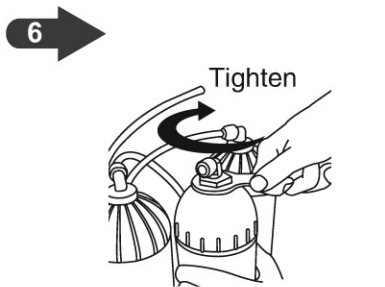
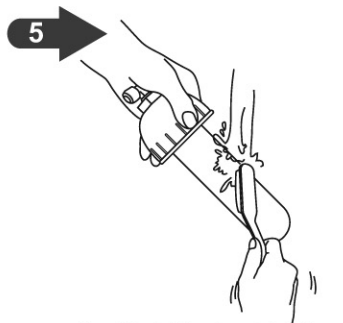
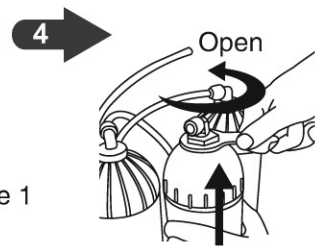
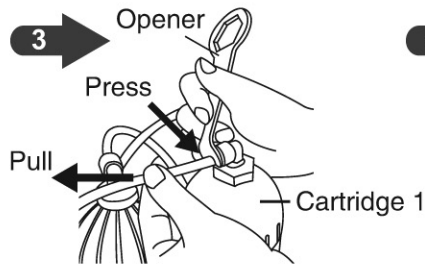
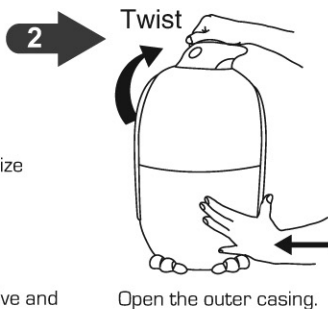
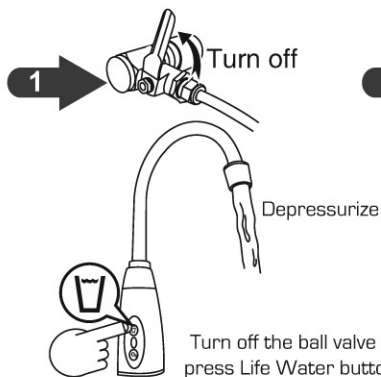

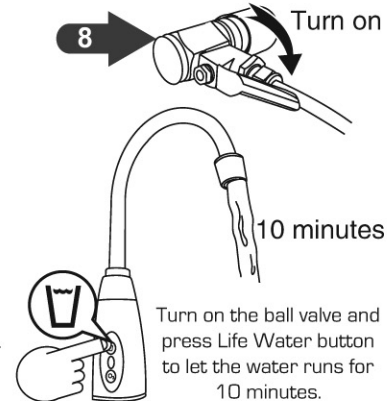
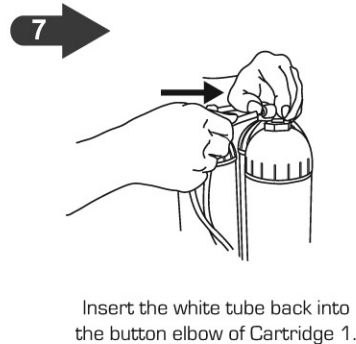
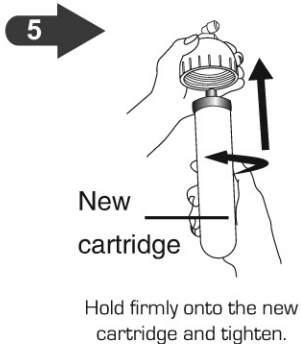
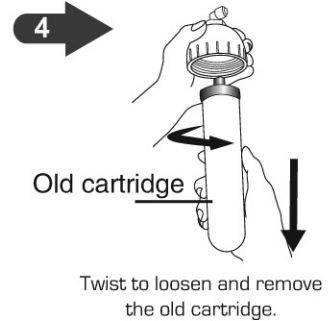
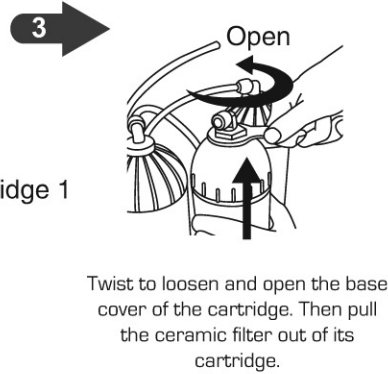
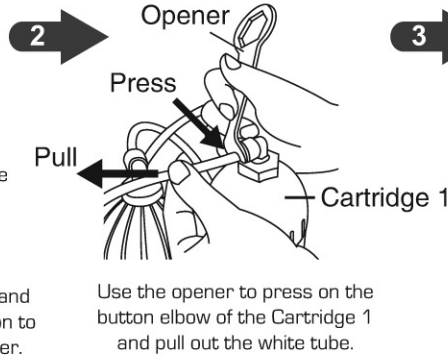
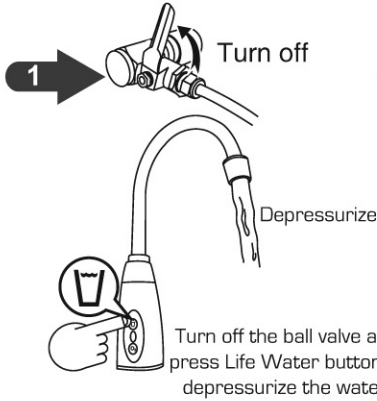

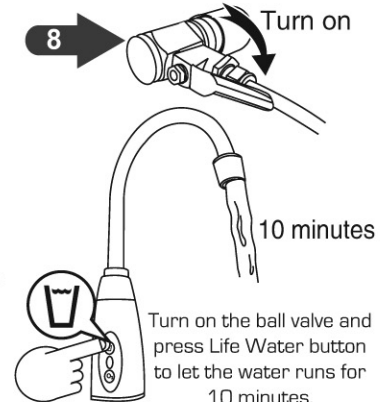
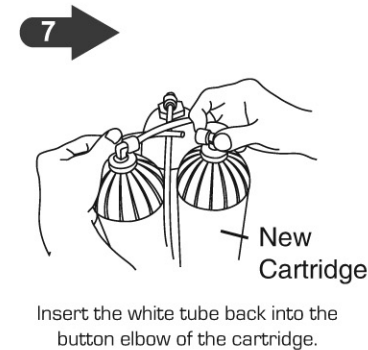
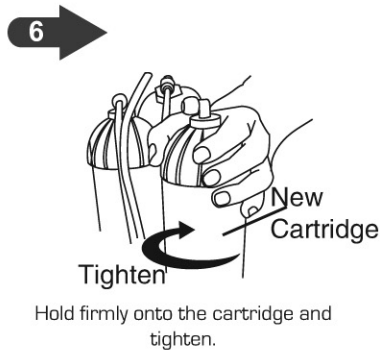
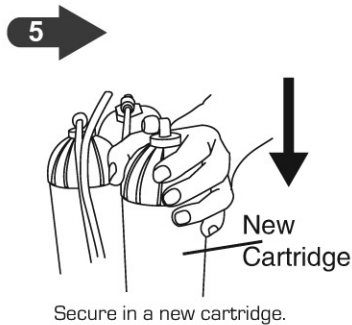
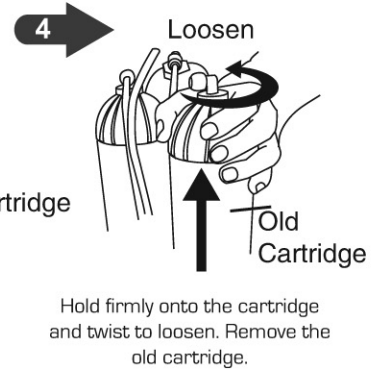
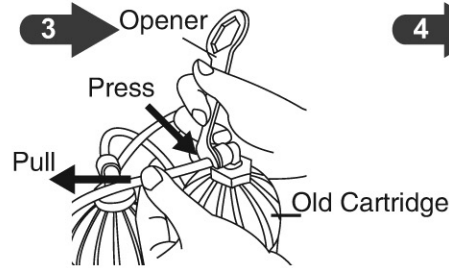
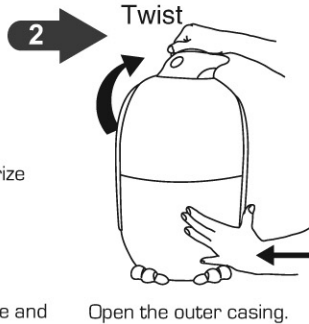
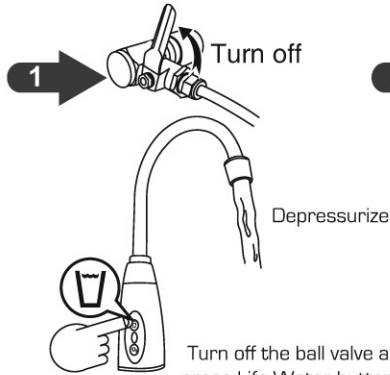

Troubleshooting

If there is malfunction in the product, please refer below for troubleshooting before calling our Customer Careline.

Why Blockage?

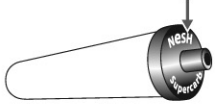

Are you using genuine Nesh ceramic cartridge?

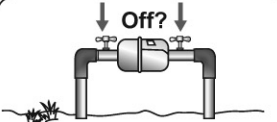

Check your main water supply. Is it turned off?



Is your ceramic cartridge expired?

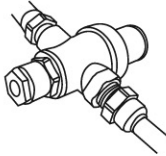

If the water pressure is too low or too high, please check the reducer valve has been set correctly.

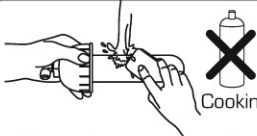

Do you clean your ceramic cartridge the correct way? Check for any damages or blockages on the surface.

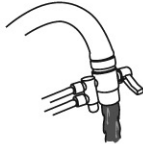

Severe water pollution in the area?

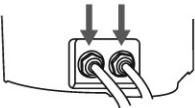

Wrong insertion in the white tube?

Algae built-up
Do you clean your ceramic cartridge regularly?

Tip: To clean the ceramic cartridge every 2 to 3 days, depending on the water quality in your area.

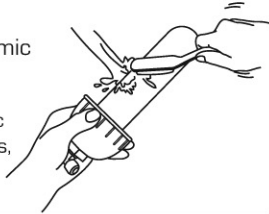

Product Lifespan When to Replace Your Cartridge?

- The lifespan of your ceramic cartridge may vary from case to case, depending on the maintenance, water quality, usage frequency and capacity.
- The lifespan of each cartridge:
Cartridge 1: 6-12 months or wear and tear
Cartridge 2: 1 year or up to 5,000 gallons
Cartridge 3: 3 year or up to 12, 000 gallons
- White tube: To be changed every 1 year
- Silicone tube: To be changed every 2 years

Tip: Beware of imitation. Genuine Nesh cartridge has the unique NESH security hologram sticker.



1. The company warrants that this product and/ or its genuine parts/ accessories are free from defects in material and workmanship, at the time of its original purchase by a consumer.
2. If during the warranty period, this product fails to operate under normal use and service, due to defects in design, materials and workmanship, The company authorized distributors or service partners will at their option, either repair or replace the product in accordance with the terms and conditions stipulated herein.
3. The company and its service partners reserve the right to charge a handling fee if a returned product is found not to be under warranty according to the terms and conditions below.

Terms & Conditions

1. This warranty is valid with the original proof of purchase issued to the original purchaser by the company authorized dealer. The company reserves the right to refuse the warranty service if there is no original proof of purchase.
2. This warranty does not cover any failure of the product due to normal wear and tear, or due to misuse, including but not limited to use in other than the normal and customary manner, in accordance with the company instructions for use and maintenance of the product. Nor does this warranty cover any failure of the product due to accident, hardware modification or adjustment, acts of God or damage resulting from shock and impact.
3. This warranty does not cover product failures which have been caused by use of accessories or other peripheral devices which are non Authorised personnel.
4. This warranty does not cover product failures which have been caused by use of accessories or other peripheral devices which are non branded original accessories intended for use with the product.
5. There are no expressed warranties, whether in written or oral, other than this printed limited warranty. All implied warranties, including without limitation the implied warranties of merchantability or fitness for a particular purpose, are limited to the duration of this limited warranty. In no event shall the company or its licensors be liable for incidental or consequential damages of any nature whatsoever, including but limited to lost profits or commercial loss, to the full extent those damages can be disclaimed by law.



Emperor Qoozo
Is Good!