

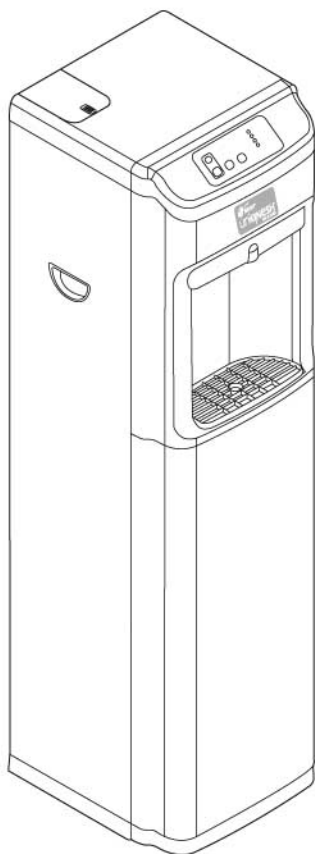

uniQ**NESH**TM hot & cold

Model: EM3013-N



User's Manual

Thank you for purchasing this Nesh product. Please read this manual thoroughly before using your new Nesh's product and retain for future reference.

Thank you for choosing uniQNEsh! It provides quality water supply, 24 hours a day, 7 days a week. Ultimate cost and time effective water solution.

In this manual, you will find useful information regarding your product including the identification of parts, installation guide, maintenance, and safety tips.

Contents

Part/Accessory Identification	01	Installation Guide & Operation Method	05
Safety Information	02	Care & Maintenance	07
Installation Guide	03	Limited Warranty	11

Part/Accessory Identification

01

uniQNEsh comes with a range of accessories to accommodate and complete NESH Life Water Filtration System function and process.

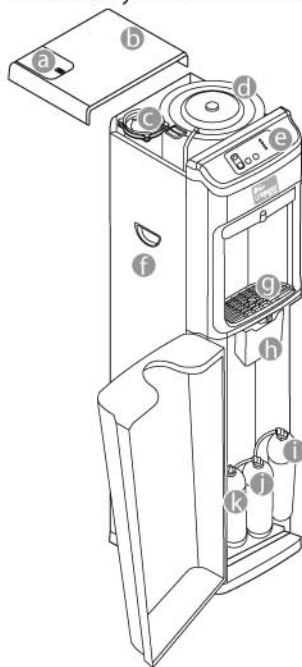

- | | |
|--------------------------|--------------------------------|
| a Lid of cup holder | h Drain container |
| b Top cover | i Cartridge 1 (Ceramic filter) |
| c Cup holder | j Cartridge 2 |
| d Cold water tank | k Cartridge 3 |
| e IC board control panel | l One-way diverter valve |
| f Hot water tank | m White tube |
| g Drip tray | |



Specifications

Name	: uniQNEsh Hot & Cold
Model	: EM3013-N
Weight	: 25kg
Dimension	: 33(W)x35(D)x120cm(H)
Filter Capacity	: 5000 L
Hot water temperature	: Max 95°C
Hot water capacity	: 2L
NESH Life Cold Water capacity	: 4 L

Safety Information

Please read and understand it thoroughly before installation.

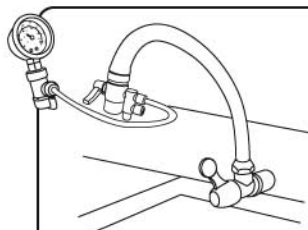

Please ensure that the maximum water pressure does not exceed 4 bars to avoid severe damage inside the ceramic filter.



When the water pressure is more than 4 bars, installation of a reducer valve is recommended to decrease the flow. When the water pressure is less than 2 bars, installation of a water pump is recommended to increase the flow.

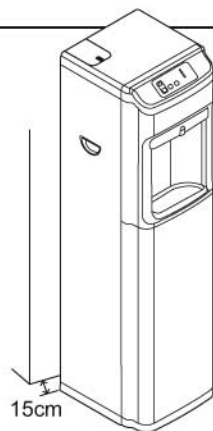

Ensure the distance between unit and wall is at least 15 cm.

- Ensure the POWER switch behind the unit, and the power supply is OFF before inserting the white tube.
- Keep away from children.
- This product is to be solely used on standard water supplies provided by utility board and treatment plants recognized by government.
- Before usage for the first time, ensure that the water tank is filled up completely before switching on the unit.
- Ensure that Cartridge1 (ceramic filter) is cleaned at least once a month to prolong its lifespan.
- Do not attempt to detach, modify or repair the product when problem occurs. Kindly contact our Customer Careline for assistance.
- Use only NESH approved accessories and spare-parts with this unit.
- Use a power output no more than 220V-240V.
- Do not place the unit under direct sunlight or high temperatures.

To check your water pressure and installation of water pump/ reducer valve.
Kindly contact NESH Customer Careline for further assistance.

Installation Guide

Above the sink outlet

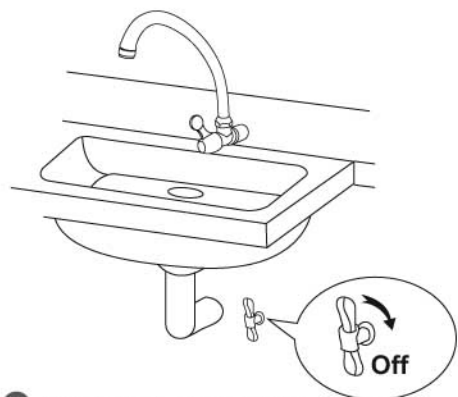

- 1 Turn OFF the main water supply.

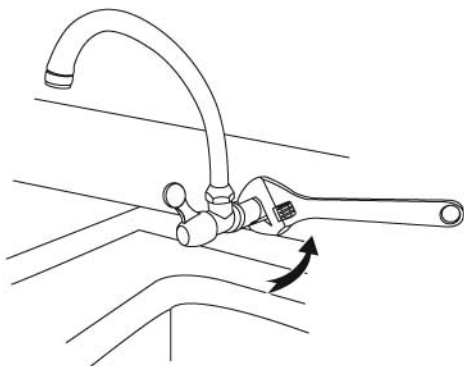

- 2 Unscrew the tap from the pipe.

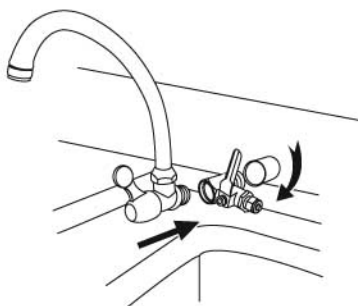

- 3 Attach one end of the one-way diverter valve to the piping and the other end to the tap.

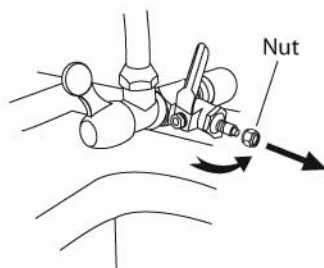

- 4 Once attached properly, unscrew the nut on the one-way diverter valve.

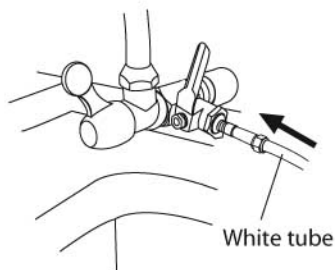

- 5 Attach the white tube to the one-way diverter valve.

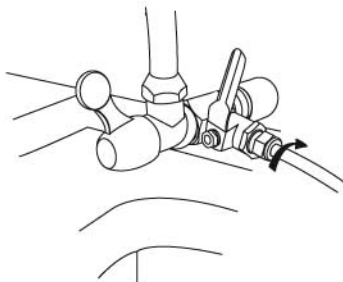

- 6 Tighten the nut to secure the white tube.

Installation Guide

Below the sink outlet

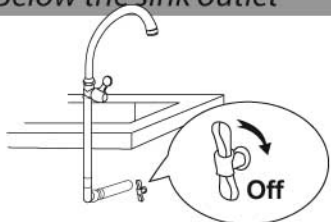

- 1** Turn OFF the main water supply.

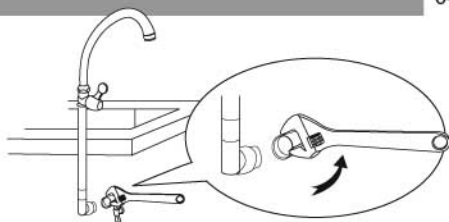

- 2** Unscrew the tap from the pipe.

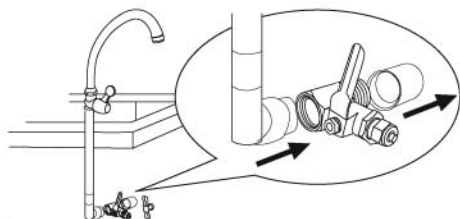

- 3** Attach one end of the one-way diverter valve to the piping and the other end to the tap.

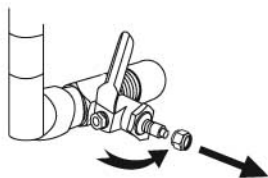

- 4** Once attached properly, unscrew the nut on the one-way diverter valve.

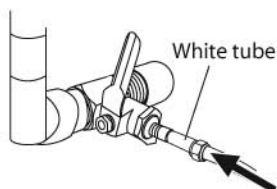

- 5** Attach in the white tube to the one-way diverter valve.

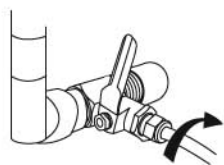

- 6** Tighten the nut to secure the white tube.

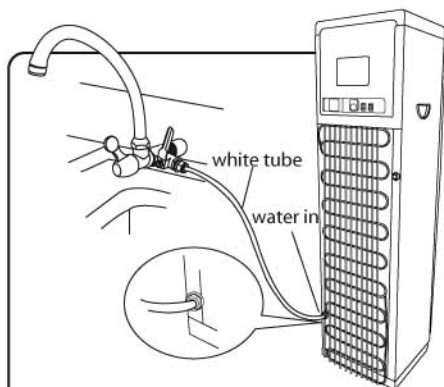

7 Above the sink

Take the other free end of the white tube and secure it to the back of the unit.

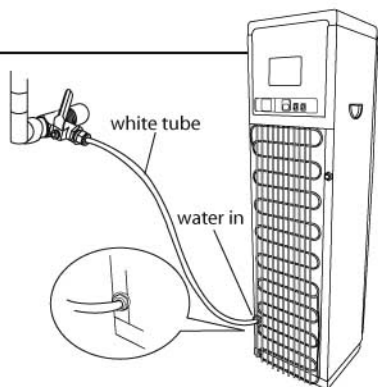

7 Below the sink

Take the other free end of the white tube and secure it to the back of the unit.

Installation Guide & Operation Method

Final Steps (above & below the sink outlets)

05

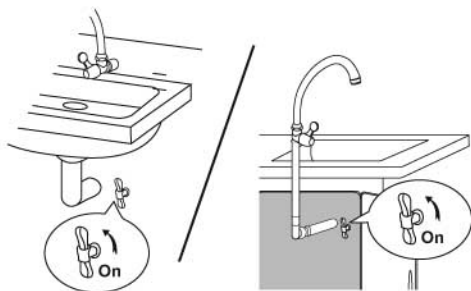

- 8 Turn ON the main water supply.

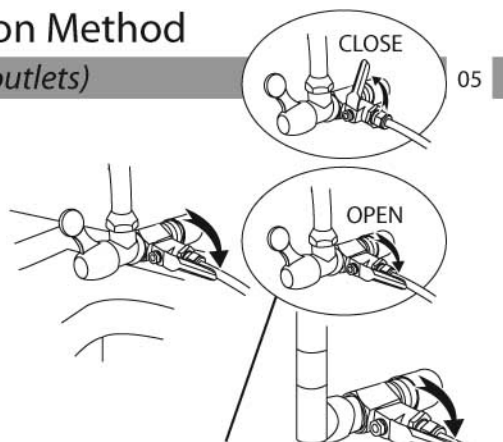

- 9 Turn the one-way diverter valve 90° downwards to OPEN position.

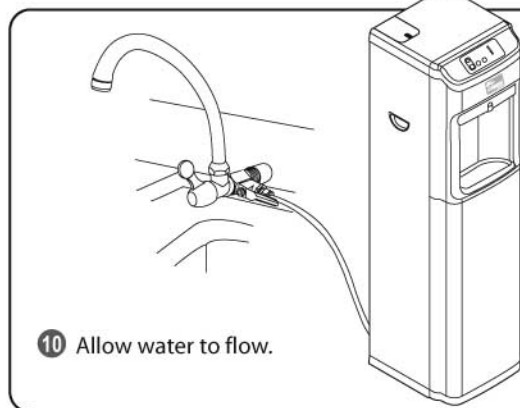

- 10 Allow water to flow.

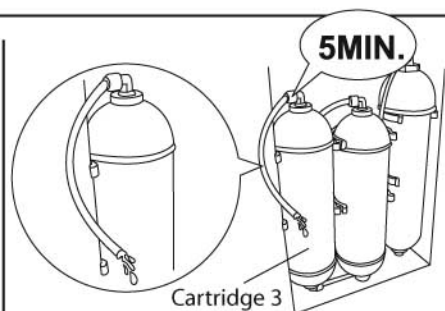

- 11 Clean Cartridge 3 for 5 minutes.

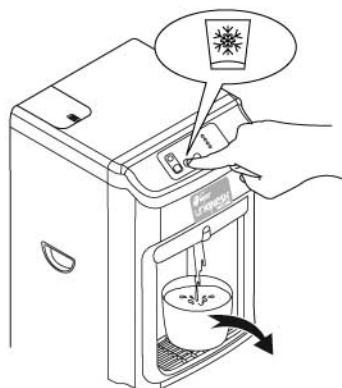

- 12 When piping cleaning is completed, the tanks will begin to fill with water. Now the machine may be connected to electricity. Try pressing the cold and hot water buttons and see if water comes out. It is important that the tanks must be filled with water to proceed the following procedures.

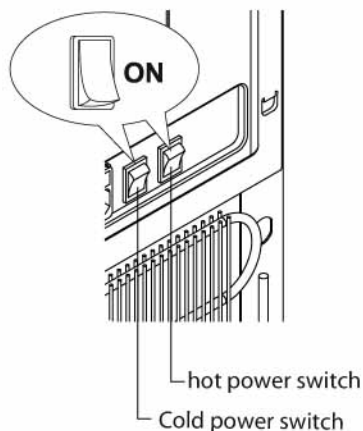

- 13 Turn on the cold power switch on the back and chilling starts. The chilling indicator on the control board will go on as chilling proceeds. When the indicator goes off, chilling is done. The temperature is set at 4 ~10°C.

Turn on the hot power switch on the back and heating starts. The heating indicator goes on while heating proceeds. When the indicator is off, heating is done and hot water is ready to serve. Hot water will be re-heated automatically when the temperature is not high enough.

- 14 To have hot water, press the **a** safety lock first, then press **b** hot water button. After 5 seconds, the hot water button locks up automatically.
- 15 To have ambient temp water, press the **d** ambient water button.



- | | |
|-------------------------------|------------------------------------|
| a Safety lock | e Hot power indicator |
| b Hot water button | f Cold power indicator |
| c Cold water button | g Heating system indicator |
| d Ambient water button | h Chilling system indicator |

Cleaning Tips:

To prolong product lifespan, we recommend cleaning Filter 1 (ceramic filter) frequently (every 3 days preferably) depending on the water quality in your area. The NESH Filter Brush is the perfect companion for a safer and more effective cartridge clean.

Care & Maintenance

Cleaning Your Ceramic Filter (Cartridge 1)

07

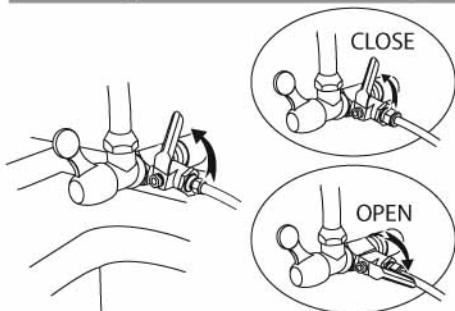

- 1 Turn the one-way diverter valve 90° upwards to CLOSE position.



- 2 Press down the white tube on the cartridge.

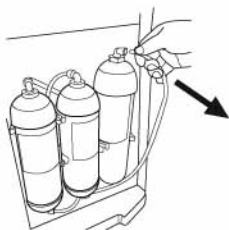

- 3 Then proceed to pull out the white tube.



- 4 Twist and open the top cover.



- 5 Pull out the ceramic filter.



- 6 Use an NESH filter brush to clean off any residue or dirt, then rinse.



- 7 Place the ceramic filter back into the casing and tighten the top cover. Ensure that the O-Ring is placed correctly.



- 8 Press down and secure the tube back into the cartridge.

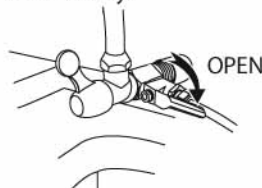

- 9 Turn the one-way diverter valve 90° downwards to OPEN position.

Care & Maintenance

Cleaning Tips:

Use only a damp cloth to clean the uniQNEsh exterior.
Please do not use hard sponges or abrasive detergents.

Replacing Your Ceramic Filter (Cartridge 1)

08

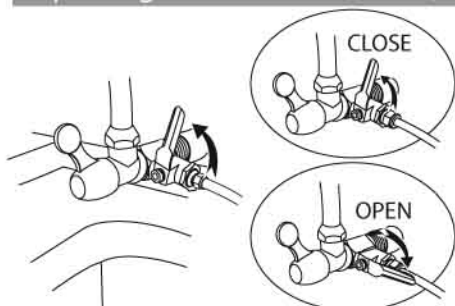

- 1 Turn the one-way diverter valve 90° upwards to CLOSE position.



- 2 Press down the white tube on the cartridge.

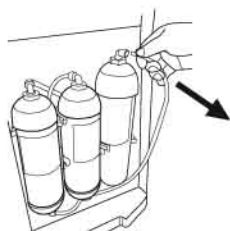

- 3 Then proceed to pull out the white tube.



- 4 Twist and open the top cover.



- 5 Pull out the ceramic filter.

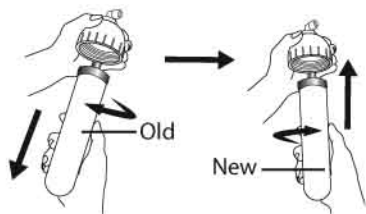

- 6 Remove the old filter from the cover with an anti-clockwise twist. Secure in the new filter with a clockwise twist.



- 7 Place the ceramic filter back into the casing and tighten the cover. Ensure that the O-Ring is placed correctly.

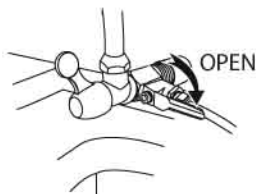

- 8 Turn the one-way diverter valve 90° downwards to OPEN position.

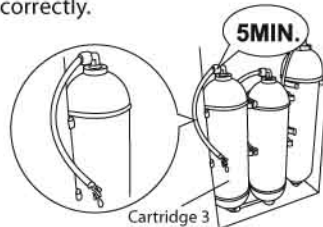

- 9 Clean Cartridge 3 for 5 minutes.

Care & Maintenance

Drain Container Instructions

09

When the float rises higher than the drip tray, as shown in drawing (A), the drain container is nearly full and must be emptied immediately. The procedures are as follows:

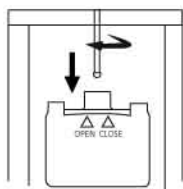
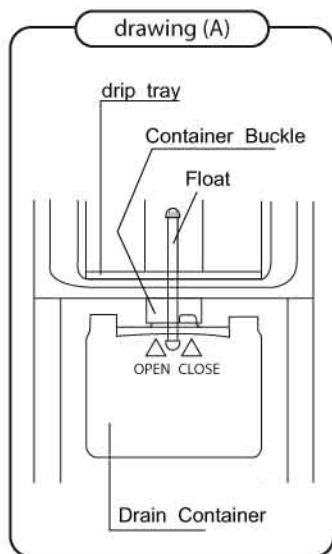

- 1 Open the front lower cover, hold the container and turn the container buckle in clockwise direction and align with the triangle sign for open. Pull down the container and pour out the water.

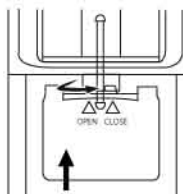

- 2 After emptying the container, insert the opening to the container buckle and turn the buckle in counterclockwise direction to align with the triangle sign for close. Make sure the container is completely attached to the buckle to prevent it from falling off.

Cup Holder Instructions

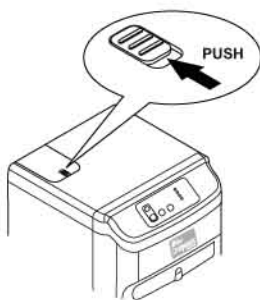

- 1 Push the clip on top of the cup holder lid.



- 2 Hold the clip, then lift up the lid as directed.

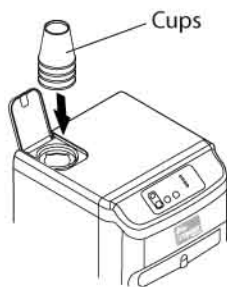

- 3 Please load the cups into the hidden cup holder with bottoms up. Push cups all the way down as the arrow is showing till no more may fit in.

Care & Maintenance

Cleaning water tank

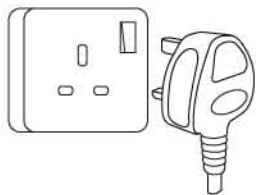

- 1 Please make sure the machine is completely disconnected from electricity before cleaning.

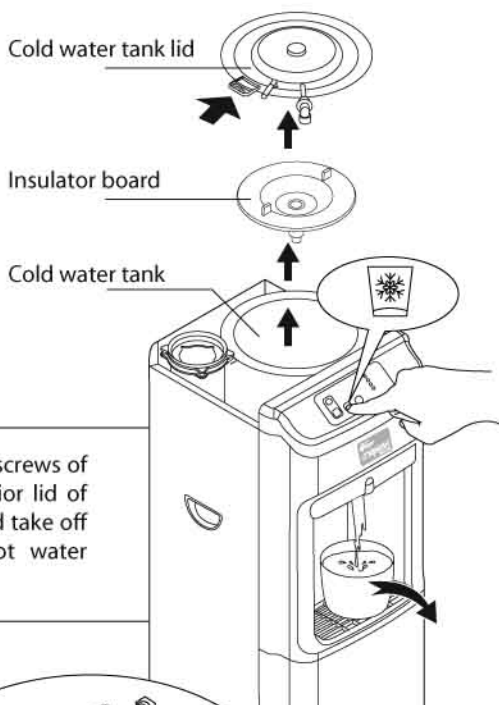

- 2 Remove the top cover by unscrewing the screws of left and right side plates. Open the interior lid of cold water tank (shown by the arrows) and take off the insulator board. Press cold and hot water buttons to let water drain out completely.

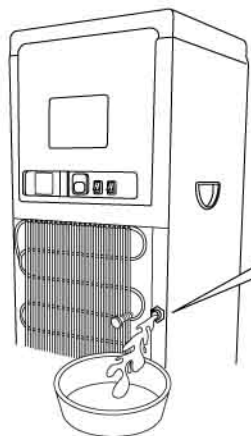

- 3 Pull out water stop bolt to drain out water from water tank.

NOTICES

1. Please prevent any water contact to the IC board or inner parts to avoid damage to the dispenser.
2. To protect the users, please contact NESH Customer Careline when the power cord or any wiring is damage and needs to be replaced.

1. This Nesh brand product, as supplied and distributed by Nesh Marketing Sdn Bhd delivered in the original carton to the original consumer purchaser, is warranted by Nesh against manufacturing defects in materials and workmanship for a limited warranty period.
2. If product fails to operate under normal use and service, warranty service can only be performed by a Nesh authorized distributors or service partners. Nesh and its service partners will repair or replace any part found to be defective, at our option.
3. Nesh and its service partners reserve the rights to impose handling charges if the returned product is not applicable to warranty under the terms and conditions below:

Terms & Conditions

1. The original dated bill of sale must be presented upon request as proof of purchase to Nesh authorized distributors or service partners.
2. This limited warranty does not cover the damage by acts of nature, normal wear and tear, damage due to mishandling or negligence, accidents, altered product or serial numbers; failure to follow Nesh's operating instructions, cleaning, maintenance and environmental instructions that are covered and prescribed in the instruction book.
3. This limited warranty does not cover product failure caused by installation, modifications, repair or service performed by NON-Nesh authorized distributors or service partners.
4. This warranty does not cover product failures which have been caused by use of accessories or other peripheral devices which are non NESH branded original accessories intended for use with the product.
5. There are no express warranties other than those listed and described above, and no warranties whether express or implied, including, but not limited to any implied warranties of merchantability or fitness for a particular purpose shall apply after the express warranty periods stated. Nesh shall not be liable for loss of revenue or profits, incidental or consequential damages caused by the use, misuse or inability to use this product, regardless of the legal theory on which the claim is based.

◆ ALL RIGHTS Reserved @ 2011 NESH Marketing Sdn. Bhd.



NESH MARKETING SDN BHD (256765-A)

12, Jalan Puteri 4/2, Bandar Puteri, 47100 Puchong, Selangor, Malaysia.

Tel: 03-8060 3668 Fax: 03-8060 3778 Website: www.nesh.com.my E-mail: info@nesh.com.my