



## **NESH Life Water Filtration System (EM2008)**

### **User's Manual**

---

Please read this manual carefully before usage.  
Kindly retain for future reference.

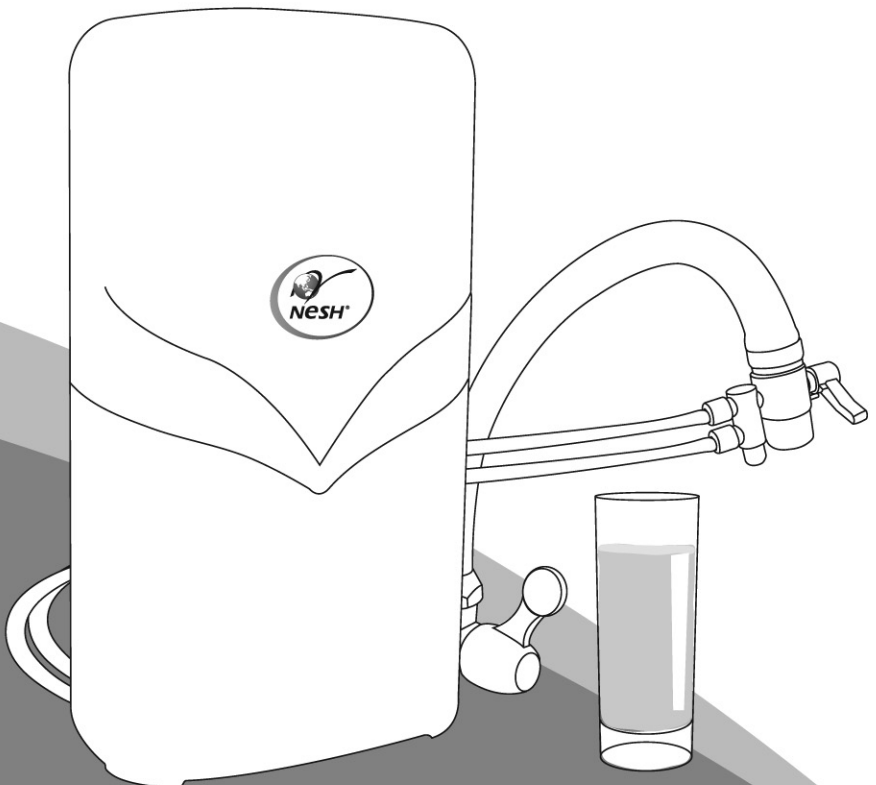

# NESH Life Water Filtration System

## User's Manual

Thank you for choosing the NESH Life Water Filtration System!

In this manual, you will find useful information regarding your product including the identification of parts, installation guide, maintenance, safety tips and troubleshooting.

## SPECIFICATION

Model: EM2008

Size: 38cm (H)x 22cm (W)

Weight: 4.2kg

Water Tap Pressure: 4 Bars

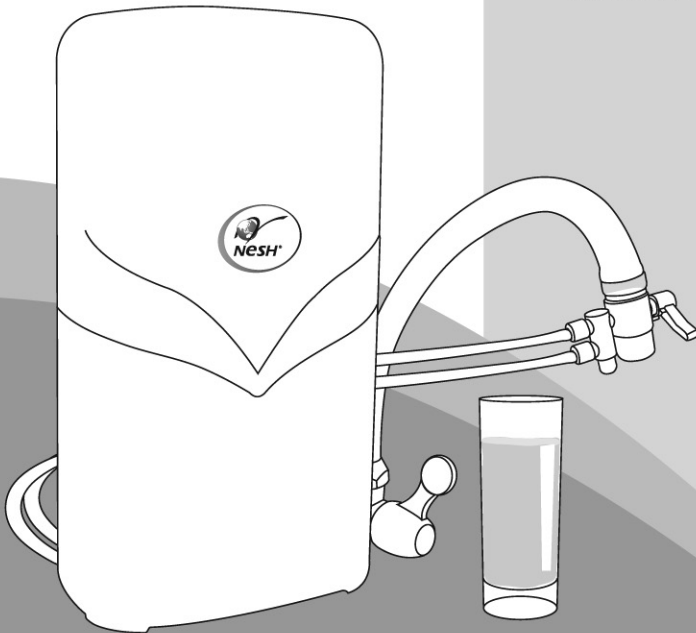

# CONTENTS

## READ THIS MANUAL THOROUGHLY

In this manual, you will find many helpful hints on how to use and maintain your water filtration system properly. Just a little preventive care on your end can save you a great deal of time and money and prolong the life span of your water filtration system.

You will find answers to common problems in the Troubleshooting section. If you review this section when problems occur, you may not need to call for service at all, saving you time and expenses.

Safety Information	.....03
Part/Accessory Identification	.....04
Installation Guide	.....05
Care & Maintenance	.....07
Troubleshooting	.....11
Limited Warranty	.....14

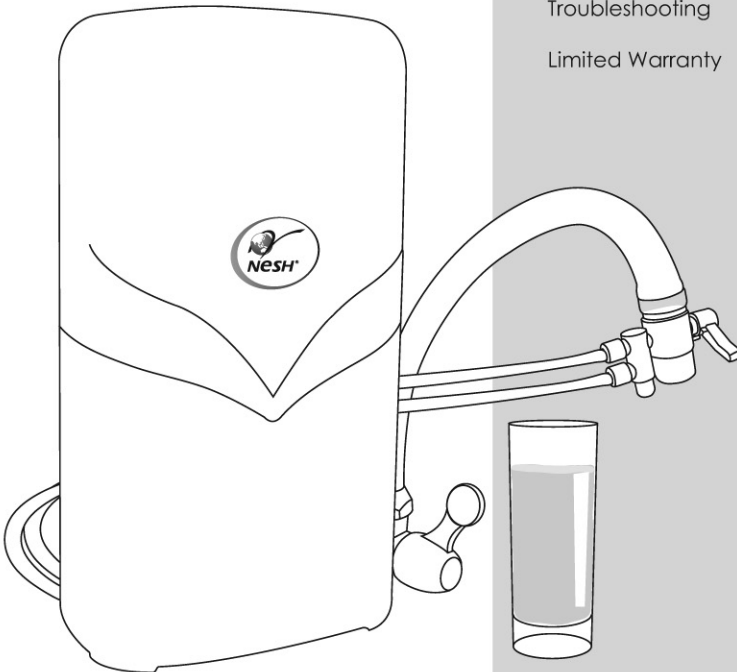

# SAFETY INFORMATION

Please read and understand it thoroughly before installation.

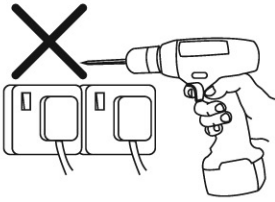

Do not drill holes on top of any electricity plugs or switches.

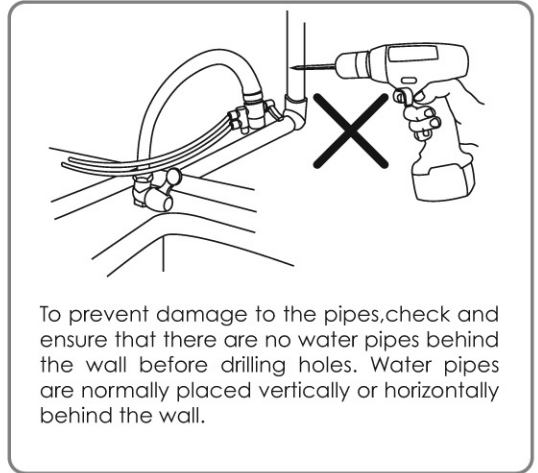

To prevent damage to the pipes, check and ensure that there are no water pipes behind the wall before drilling holes. Water pipes are normally placed vertically or horizontally behind the wall.

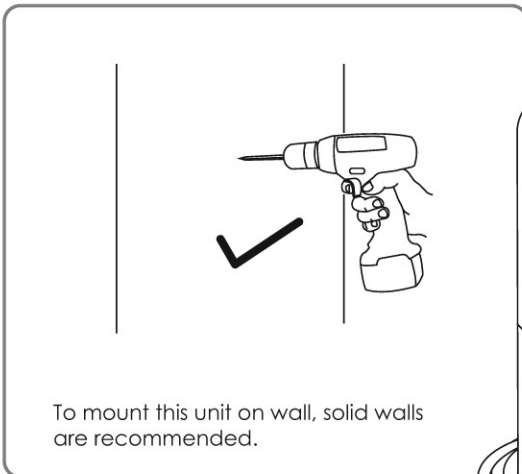

To mount this unit on wall, solid walls are recommended.

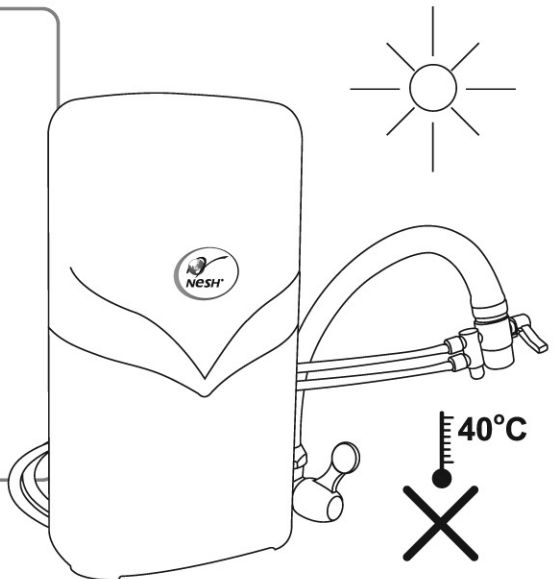

Do not place the unit under direct sunlight or temperatures exceeding 40°C.

# PART / ACCESSORY

## IDENTIFICATION

The NESH Life Water Filtration System comes with range of accessories to accommodate and complete the water filtration function and process.

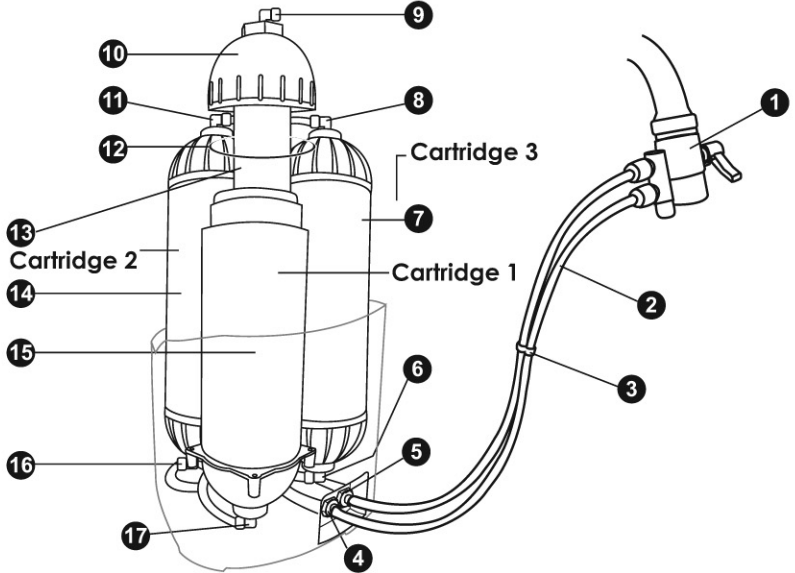

**1**



**Two Way Diverter Valve**  
HW28

**2**



**White Tube**  
R20

**3**



**Hose Ring**  
M25-03

**4**



**FZ-Elbow**  
R27

**5**



**FZ-Elbow**  
R27

**6**



**Elbow-40L**  
R28

**7**

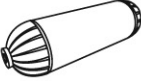

**Cartridge**  
Filter - 3

**8**



**Elbow-18PS**  
R19

**9**



**Elbow-18PS**  
R19

**10**

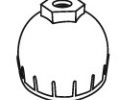

**Ceramic Cover**  
M 35(N)

**11**



**Elbow-18PS**  
R19

**12**



**O-Ring**  
R29

**13**



**Ceramic**  
Filter - 1

**14**

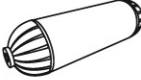

**Cartridge**  
Filter- 2

**15**



**Filter Casing with Thread & Holder**  
M32 / 33

**16**



**Elbow-40L**  
R28

**17**



**Elbow-40L**  
R28

# INSTALLATION GUIDE

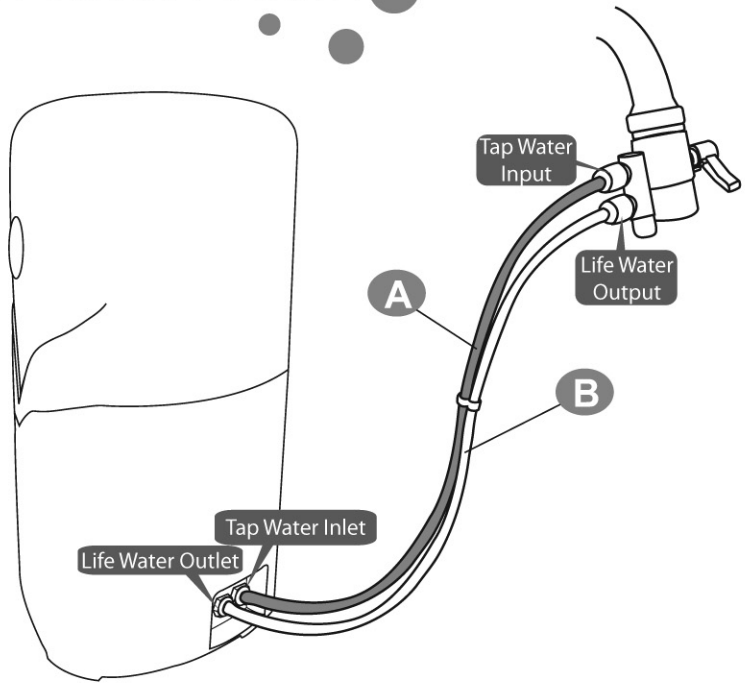

## Connection "A"

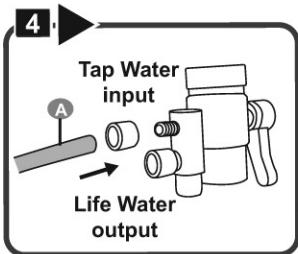
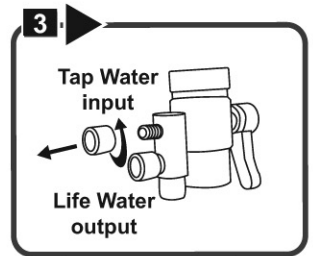
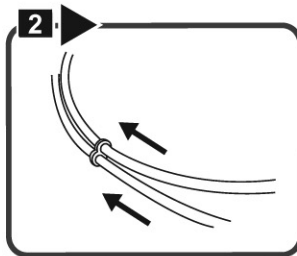
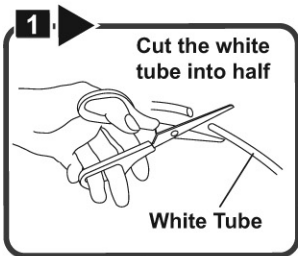

Attach white tube A on top

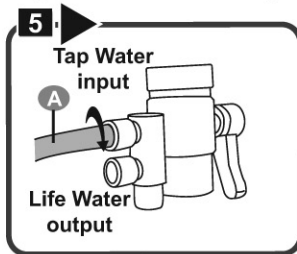

Tighten nut A

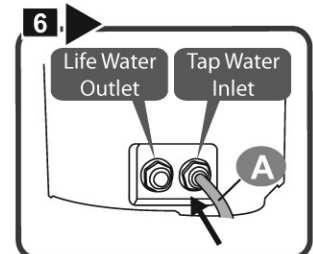

Attach white tube A to the right

# INSTALLATION GUIDE

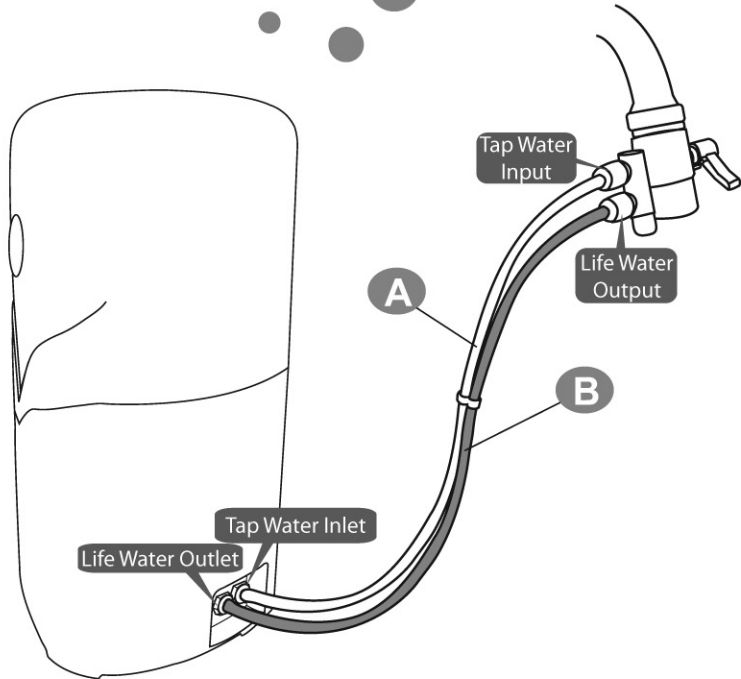

## Connection "B"

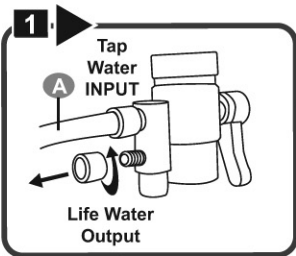

Loosen nut B

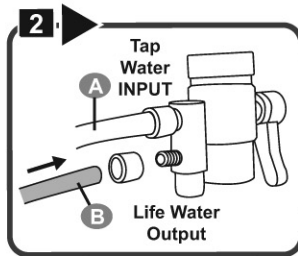

Attach white tube B below white tube A

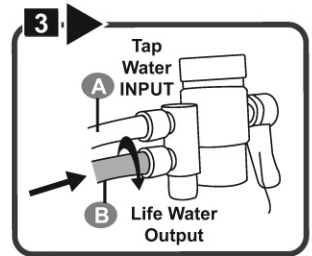

Tighten nut B

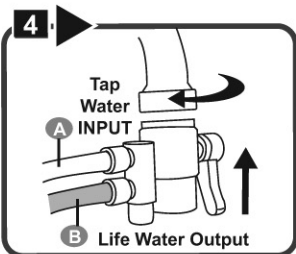

Once all tubes are fixed, attach the diverter valve to the tap & tighten

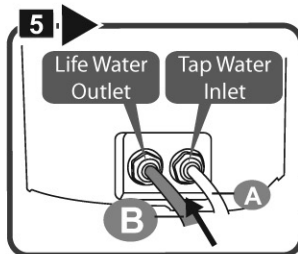

Attach white tube B to the left

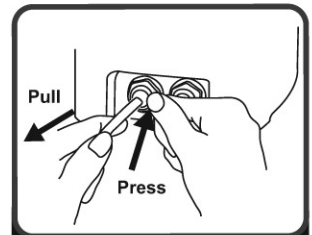

Tips: Press and pull to remove the white tube

# CARE & MAINTENANCE

NESH Life Water Filtration System is a product of superior quality and design, and must therefore be treated with care. This chapter covers information that will help you fulfil the warranty obligations in order to enjoy this product for many years to come.

## Your Filter Cartridge Lifespan (When To Replace Your Filter Cartridge)

The lifespan of a ceramic filter may vary from case to case, depending on the maintenance, water quality, usage frequency and capacity. The recommended timeframe for a cartridge replacement is as follows:

### Cartridge 1

6-12 months or wear and tear (2-week warranty)

### Cartridge 2

1 year or after 5,000 gallons (1-year warranty)

### Cartridge 3

3 year or after 12,000 gallons (1-year warranty)

**Tip:** Only original cartridges have the unique NESH security hologram sticker. Please beware of imitations.





# CARE & MAINTENANCE

## Cleaning Your Ceramic Filter (Cartridge 1)

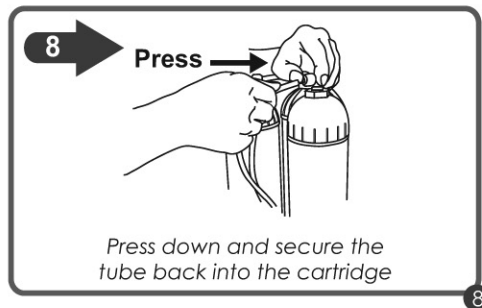
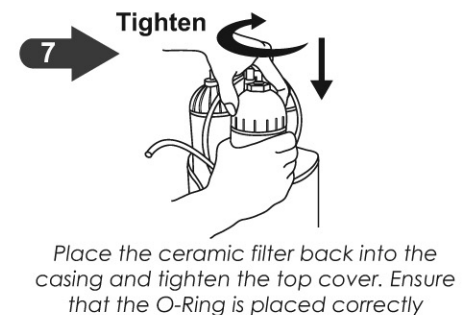
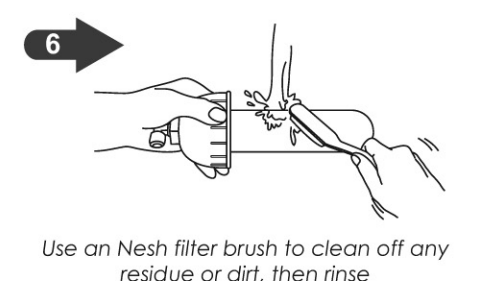
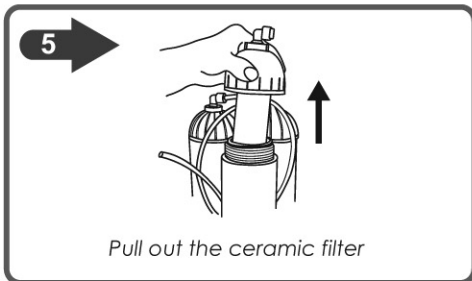
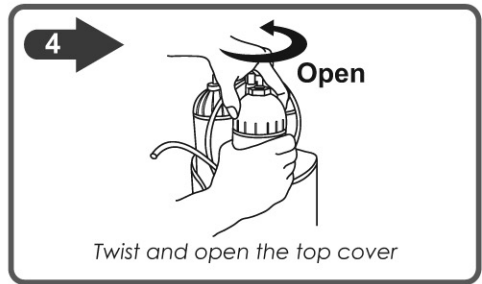
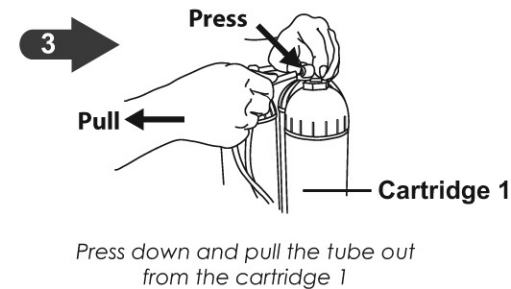
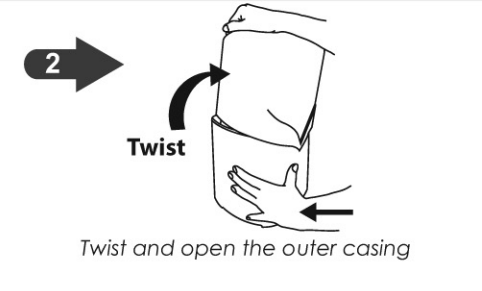
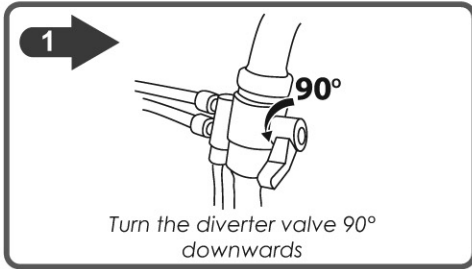

# CARE & MAINTENANCE

## Replacing Your Ceramic Filter (Cartridge 1)

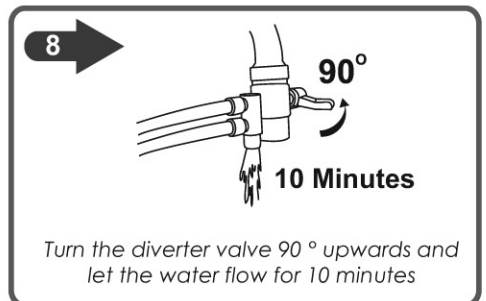
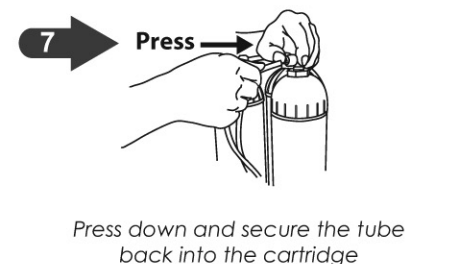
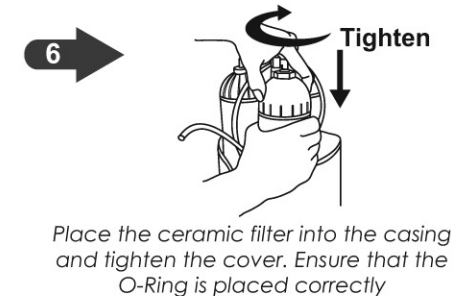
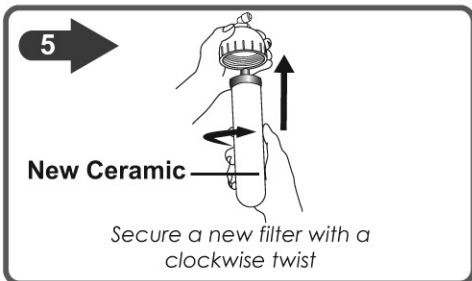
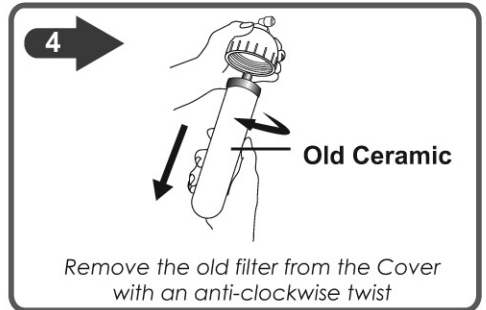
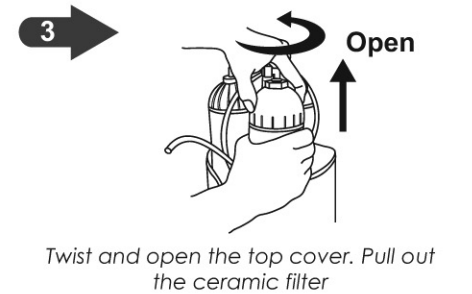
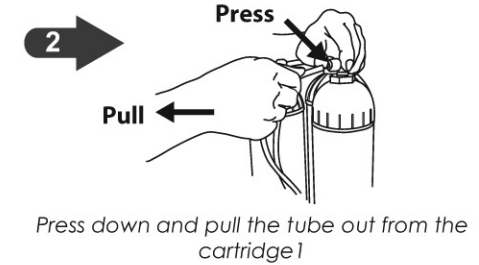
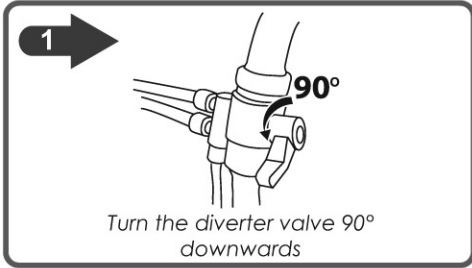

# CARE & MAINTENANCE

## Replacing Cartridge 2 & Cartridge 3

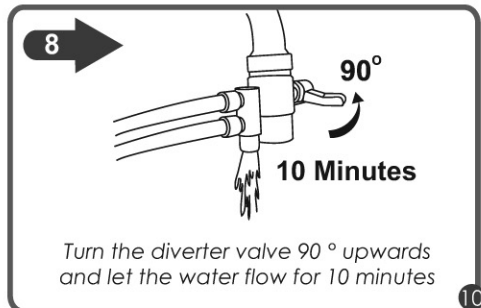
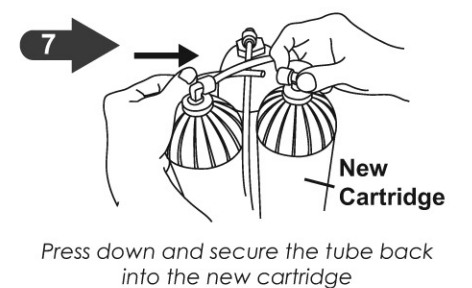
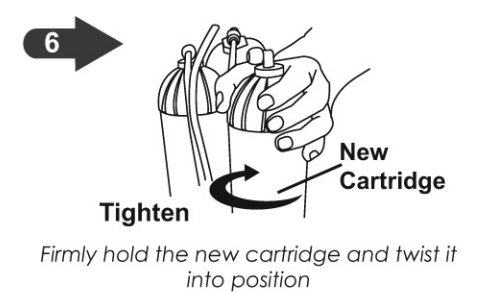
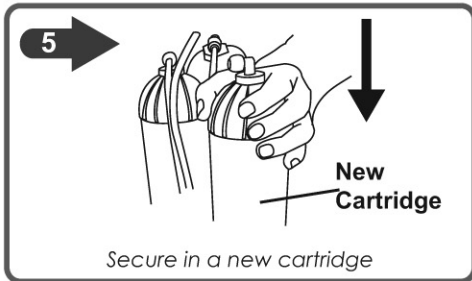
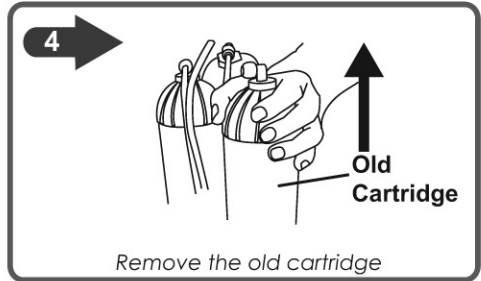
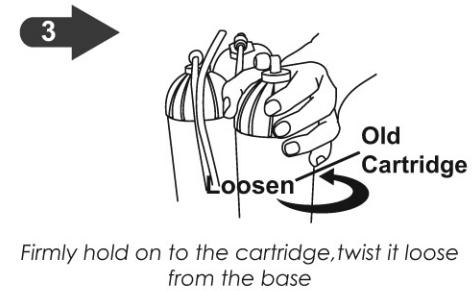
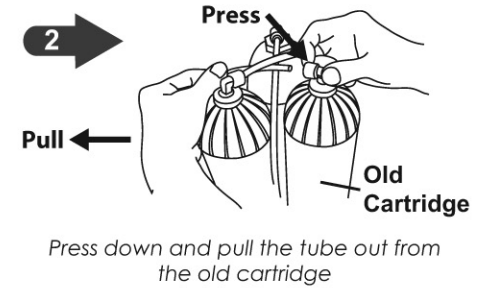
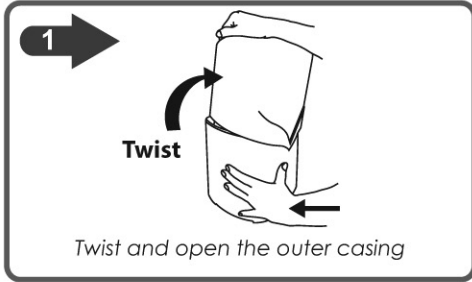

# TROUBLESHOOTING

Before contacting our Customer Service Consultant, perform the following simple checks. It may save you the time and expense of unnecessary service calls.

## Problems

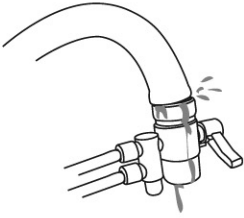

**When the diverter valve cannot be fixed or is very loose on the tap**

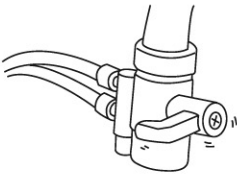

**When the diverter valve loosens with time and usage**



**When water flows out from both water outlets at the same time**

## Solutions

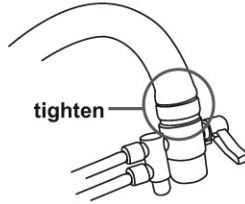

*Change a new tap as the existing threads is unable to fit the threads of the diverter valve.*

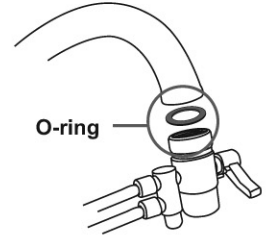

*Change to a thinner o-ring for the diverter valve.*

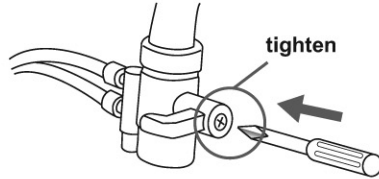

*Tighten the screw located at the right side of the diverter valve.*

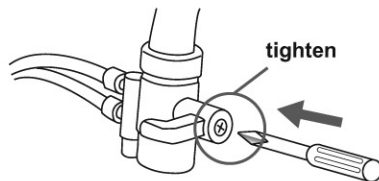

*Tighten the screw located at the right side of the diverter valve.*

# TROUBLESHOOTING

## Problems

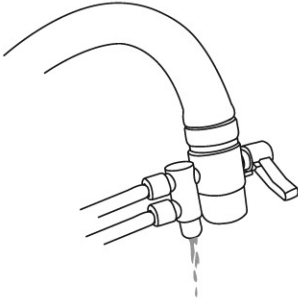

**When the Life Water flow  
is slow**

## Solutions

- Check whether the water pressure is too low (below 2 bars).
- Check for any damages or bends on the white tubes.
- Ensure that the filter brush is clean and not contaminated by any residue, soap or oil
- Ensure that the filter has been regularly cleaned and not blocked by any residue, soap and oil.

### **Important**

*Cleaning the Ceramic Filter cartridge without a proper filter brush may result in the accumulation of residue and particles on the surface of the filter, causing slow water flow and subsequently blockage.*

# TROUBLESHOOTING

## When blockage occurs

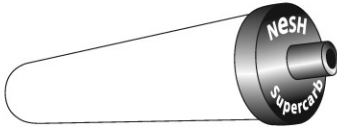

Ensure that your cartridges are genuine NESH parts / accessories

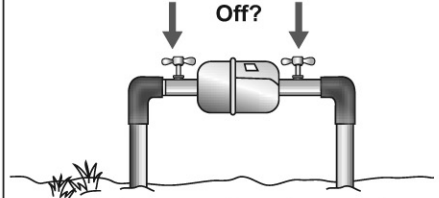

Check your main water supply.  
Is it turned off?

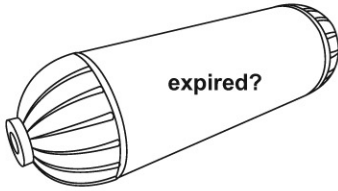

Check your filter cartridge expiration

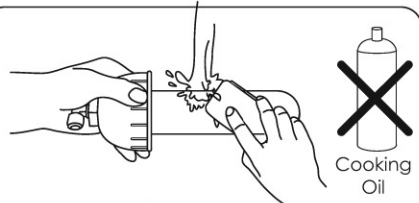

Check for any damages or blockages on your filter surface due to accumulated residue

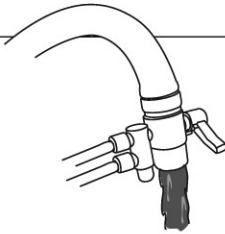

Ensure that your residential area is not experiencing any extreme water pollution

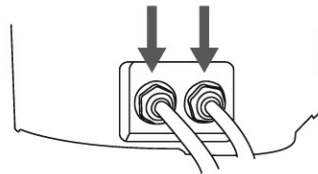

Check the insertion of the white tubes in their proper outlets

### Useful Tip:

To clean off the algae build-up on your ceramic filter, we recommend cleaning it every 2-3 days depending on the water quality in your area. The NESH Filter Brush is the perfect companion for a safer and more effective cartridge cleanse.

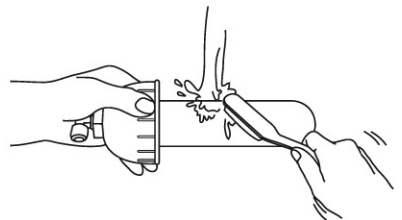

# Limited Warranty



1. NESH Marketing Sdn.Bhd.warrants that this NESH product and/or its genuine NESH part/accessories are free from defects in material and workmanship,at the time of its original purchase by a consumer.
2. If during the warranty period,this product fails to operate under normal use and service,due to defects in design,materials and workmanship,NESH authorised distributors or service partners will at their option,either repair or replace the product in accordance with the terms and conditions stipulated herein.
3. NESH and its service partners reserve the right to charge a handling fee if a returned product is found not to be under warranty according to the terms and conditions below.

## Terms &Conditions

1. This warranty is valid with the original proof of purchase issued to the original purchaser by a NESH Authorised dealer. NESH reserves the right to refuse the warranty service if there is no original proof of purchase.
2. This warranty does not cover any failure of the product due to normal wear and tear, or due to misuse, including but not limited to use in other than the normal and customary manner, in accordance with the NESH instructions for use and maintenance of the product. Nor does this warranty cover any failure of the product due to accident, hardware modification or adjustment, acts of God or damage resulting from shock and impact.
3. This warranty does not cover product failures caused by installations, modifications, repair or opening of the product performed by non-NESH Authorised personnel.
4. This warranty does not cover product failures which have been caused by use of accessories or other peripheral devices which are non-NESH branded original accessories intended for use with the product.
5. There are no expressed warranties, whether in written or oral, other than this printed limited warranty.



**NESH MARKETING SDN BHD**

(256765-A) (AJL93067)

12, Jalan Puteri 4/2, Bandar Puteri, 47100 Puchong, Selangor, Malaysia.

Tel: 03-8060 3668 Fax: 03-8060 3778

E-mail: [info@nesh.com.my](mailto:info@nesh.com.my) Website: [www.nesh.com.my](http://www.nesh.com.my)